

Technical data for hinge

W-Tec 3Ds Concealed hinge

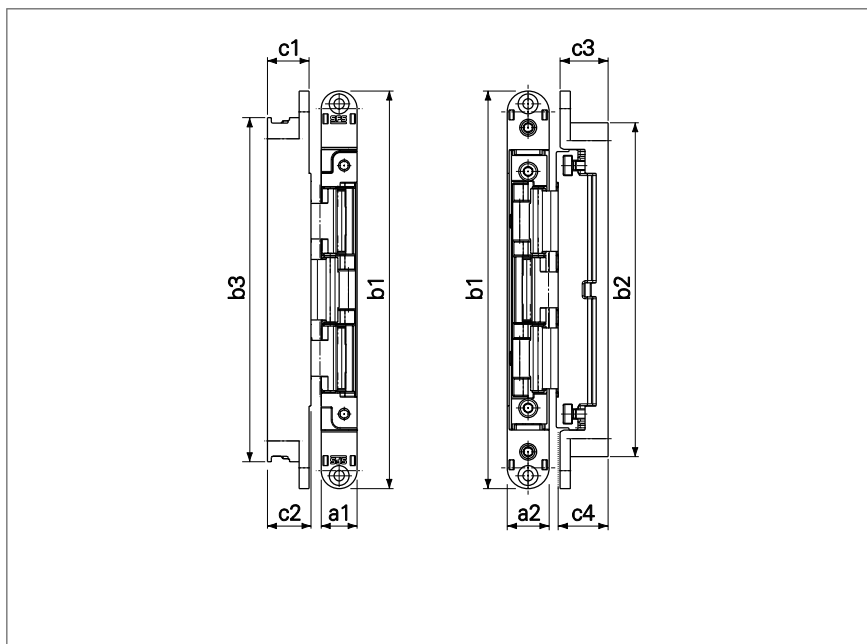

a1:	18,0 mm
a2:	21,0 mm
b1:	200,0 mm
b2:	168,0 mm
b3:	173,0 mm
c1:	21,0 mm
c2:	22,0 mm
c3:	24,0 mm
c4:	25,0 mm

Solid timber application

Steel frame application

Material: Zamak

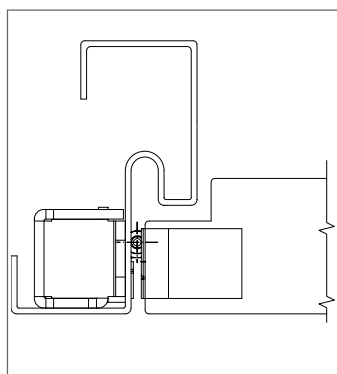
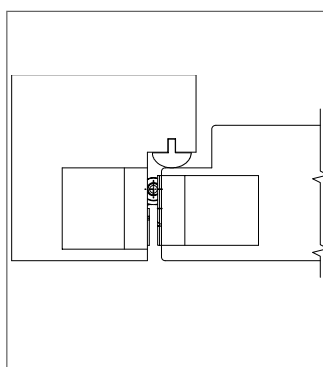

Surface treatment:

- Zinc GSS**
Zinc coated min 5 μ
- Matt Chrome**
Zinc coated min 5 μ + painting

Cover frame application

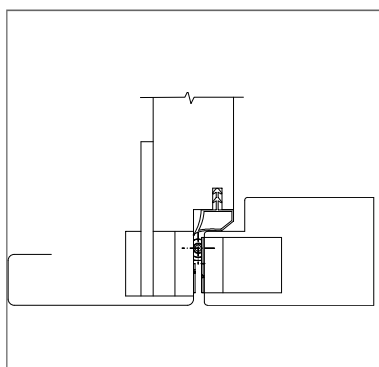

Corrosion resistance in accordance to standard
UNI EN 1670:

- Zinc GSS** min. 310 hours
- Matt Chrome** min. 432 hours

Test in accordance to RAL standards

Durbility test with 2 hinges:
Door mass

200.000 Cycles
60 Kg

Durability test

Measurements	Cycles	Vertical wear (mm)	Lateral wear (mm)
1	5.000	0,23	0,12
2	10.000	0,25	0,13
3	15.000	0,33	0,15
4	30.000	0,40	0,28
5	50.000	0,60	0,31
6	70.000	0,68	0,33
7	100.000	0,85	0,37
8	130.000	0,90	0,63
9	160.000	0,95	0,77
10	200.000	1,15	0,80
*	200.010	1,58	1,02

* overload test 10 cycles with door mass 160Kg.

General Manager:

Signature:

Date 19.05.2017



ISO 9001 : 2008 Quality Management System