

Scivola T - 16 mm forend, hub and key



Description

Embedded lock with receding hook, striker included. Made entirely of steel. 16 mm forend with round ends and single 50 mm backset. Articulated key with single differ. Striker with frontal maximum width 28 mm.

Use

Lock for internal sliding doors with hook, which throws from the lock forend and rotate onto the striker plate when closing. The coupling between door and frame is guaranteed by the extension of the lock. Is available in Kits, to be combined to different models of handles. The hub of the handle operates the hook which can be locked by the key.

Fastening

Prepare cutout and mill the panel according to the dimensions shown in the diagram. Secure the lock and striker with four 4x20 mm screws.

Note. Each pack contains a lock with striker, pocket and articulated key.

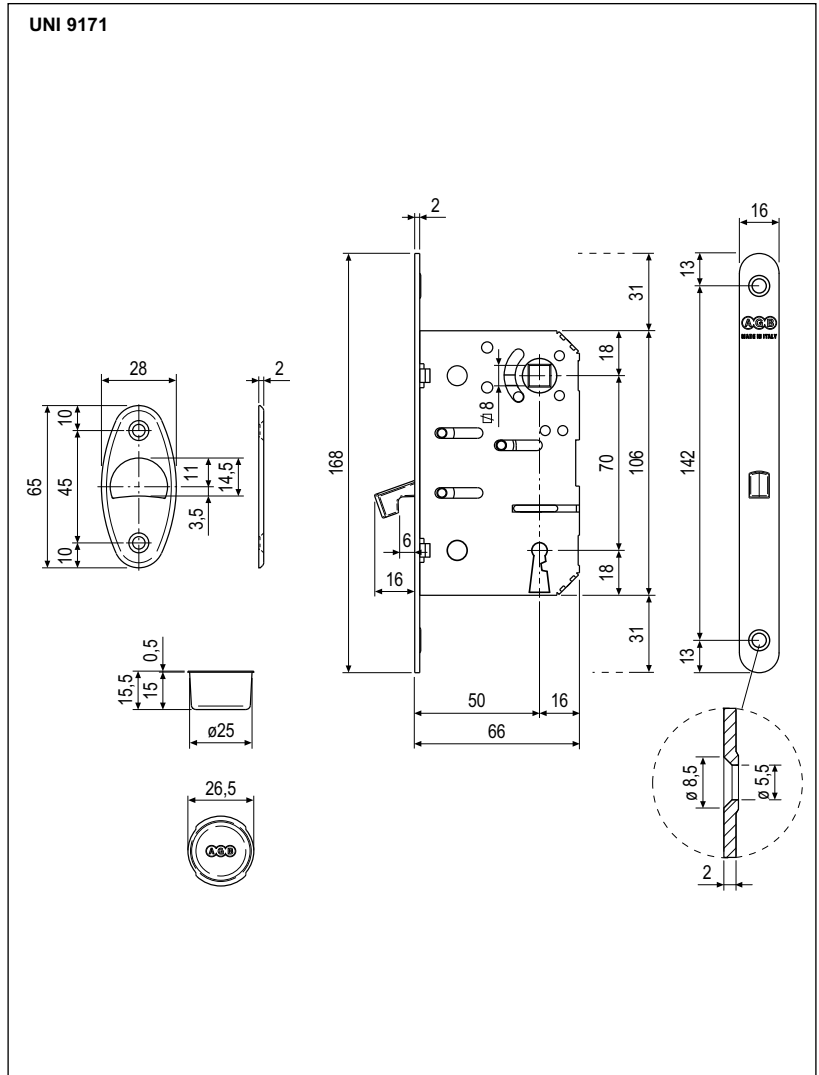

Order Specifications

Material	Article	Image
STEEL	B08901.50.XX	 1

Note. Refer to the price list in force to check the availability of the finishes.

HOOK DETAIL

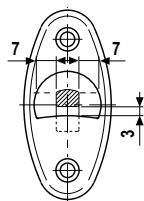

The considerable coupling tolerance with the striker, make the door always close, even facing vertical settlements after the installation (up to 3 mm) and side shiftings up to 7 mm.

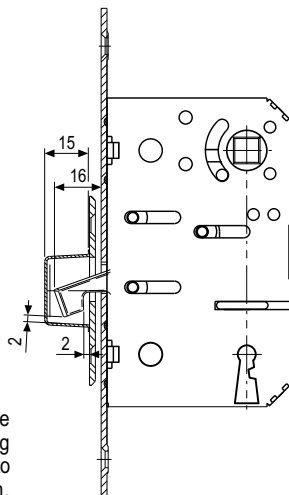

Drilling for the covering tray for Scivola T

