

# With retracting hook - forend 25 mm, + C603XX.22.22 cylinder

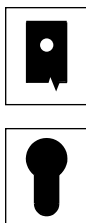

UNI 9171

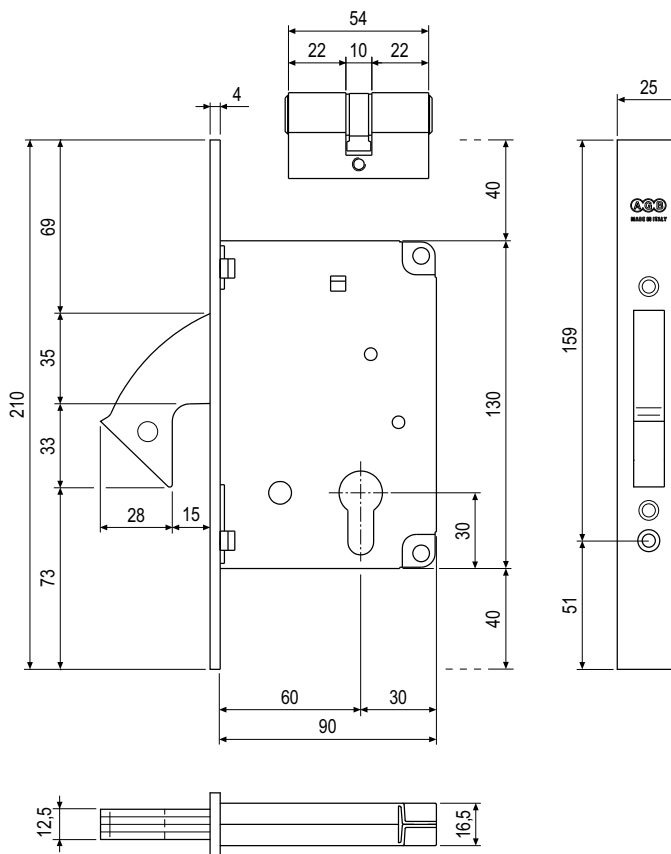

### Description

Embedded lock with return claw hook, cylinder art. C603XX.22.22 and cylinder fastening screw. The cylinder-actuated hook is made of rolled steel. The case and internal components are made of tropicalised steel. 25 mm forend with square ends. Single 60 mm backset.

### Application

Lock for heavy-duty exterior sliding doors and gates made of metal section.

### Mounting

Prepare recess in the section according to the dimensions shown in the diagram and weld the forend to the section. There is no striker for this type of lock: the hook latches directly onto the jamb.

**NB.** Each box contains a lock, a cylinder art. C603XX.22.22 and a cylinder fastening screw.



### Order Specifications

Material	SALES CODE		
	Ref.	Backset	Finish code
STEEL	B00858	60	XX

**NB.** Refer to the price list in force to check the availability of the finishes.